



ONE BLACKFRIARS  
LONDON



ONE BLACKFRIARS  
LONDON

London's Premier Landmark Tower





The Lansetti II vase created in 1952 by designer Timo Sarpaneva

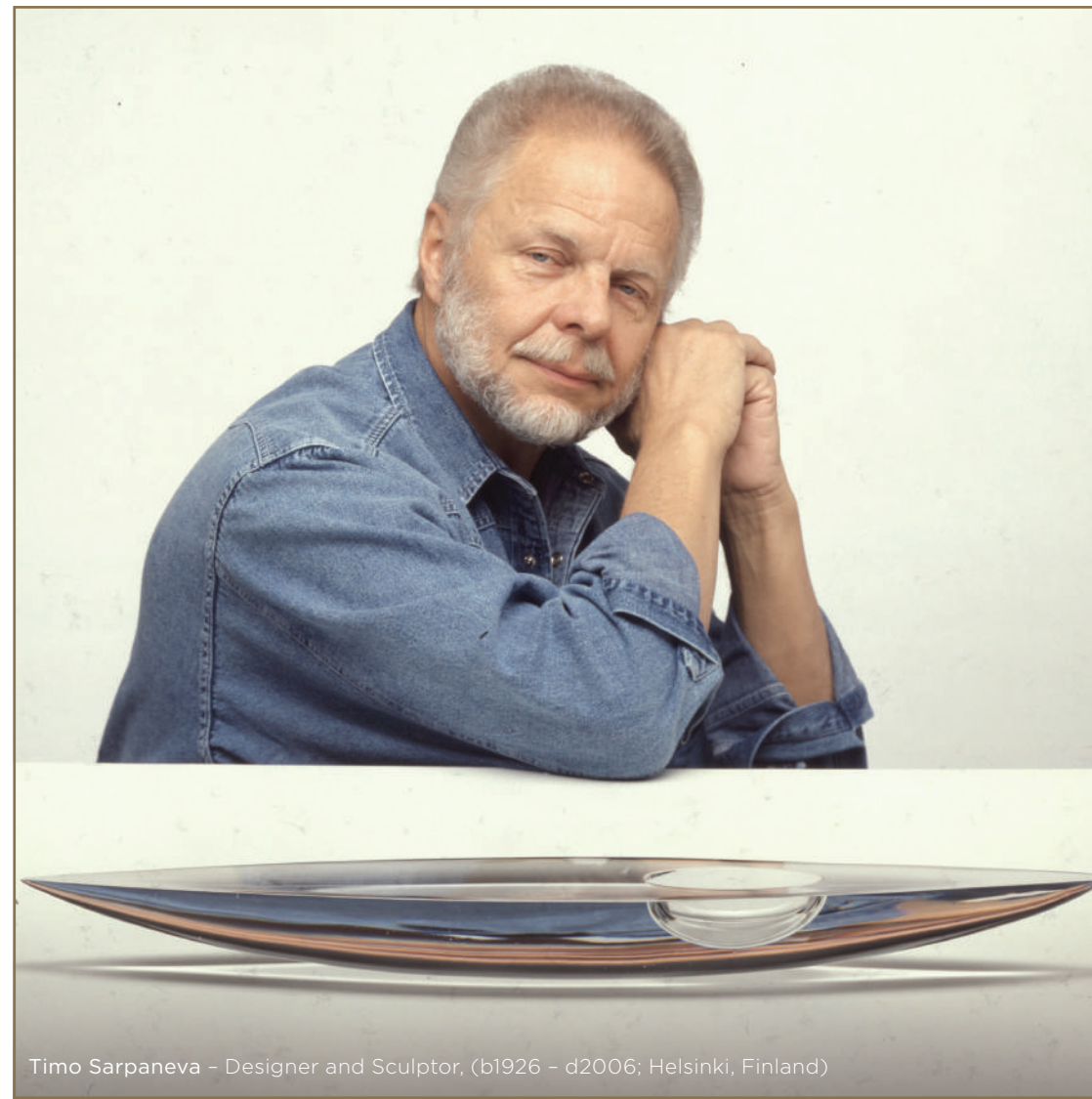

Timo Sarpaneva - Designer and Sculptor, (b1926 - d2006; Helsinki, Finland)



Ian Simpson - Architect



Tara Bernerd - Interior Designer

## ONE BLACKFRIARS

— a shimmering, new dimension to London's skyline

## ONE INSPIRATION

The Lansetti II vase by Timo Sarpaneva provided the inspiration for One Blackfriars Tower - captured in the curved geometry and transparent glass surface of the Tower. The Lansetti II vase, itself, can be viewed at the Victoria and Albert Museum in London.

## ONE VISION

"One of the world's most famous scenes, the River Thames in the heart of London, is the ribbon binding the capital together - reflecting all facets of the capital, both ancient and modern. A slender new silhouette, One Blackfriars will soon rise up - a new landmark for London, bringing vision, clarity and brilliance to the South Bank."

Ian Simpson, Ian Simpson Architects

## ONE DESIGN

One Blackfriars has brought together world-class designers - a curation of the talents in interior design, landscaping and lighting to create a global landmark and the capital's most fashionable address.





Complete generated images. The Blackfriars is indicative only.





# ONE CONCEPT

Designed by internationally renowned interior designers Tara Bernerd & Partners, the three collections are named after three leading British artists: Thomas Gainsborough, the 18th century portrait and landscape painter; J.M.W. Turner, revered for his Romantic and Impressionist landscapes and the 20th century Modernist sculptor Barbara Hepworth, to celebrate the cultural heritage of the South Bank. The collections offer a range of apartments with a choice of two design schemes.

## THE GAINSBOROUGH COLLECTION

Encompassing classical elegance, handsome features and attention to detail, The Gainsborough Collection will provide stylish studios, Manhattan and one bedroom apartments.

## THE TURNER COLLECTION

Turner was the master of light and reflections and these two and three bedroom apartments, with a high specification, exhibit exceptional use of space and lighting.

## THE HEPWORTH COLLECTION

Barbara Hepworth worked with the finest metal, stone and wood to shape her wonderful sculptures. The Hepworth Collection embodies this spirit of the connoisseur, using exquisite materials sourced from around the world to create outstanding living spaces - distinctive, contemporary apartments with the very latest technology.





Computer generated image of One Blackfriars is indicative only.



## ONE LANDSCAPE

One Blackfriars is transforming London's skyline with the 50-storey Tower creating a new focus on the banks of the River Thames among the capital's famous landmarks. The view to the east sweeps over The Shard, the dome of St Paul's and The Gherkin. Looking west, the Houses of Parliament and the London Eye offer a fascinating snapshot of old and new.





Aerial photograph of London showing location of One Blackfriars



## INTRODUCING

# ONE BLACKFRIARS

One Blackfriars is at the heart of the South Bank, creating a gateway to the historic borough of Southwark, a fascinating blend of the capital's contemporary exuberance and ancient heritage.

The district is one of London's oldest established areas and is now enjoying a renaissance as the capital's most fashionable new destination, with art galleries, theatres, restaurants, cafés and bars clustered around the South Bank of the River Thames. Its history as a centre for commerce is being revived, with global businesses such as News Corp, PwC, Ernst & Young and Norton Rose relocating to Southwark in a glistening hub around The Shard.



Computer generated image of One Blackfriars is indicative only.





# ONE SKYLINE

One Blackfriars is set to shape the capital's skyline with its distinctive sculptural elegance. The sheer beauty and purity of its design is destined to create a new focus on London's South Bank.





The London Eye



The Tate Modern



The National Theatre



Southwark Cathedral



Vinopolis



Somerset House



Borough Market



The Shard

# ONE LOCATION

Overlooking the River Thames, One Blackfriars is within close proximity to world-class venues, housing a flourishing arts scene with theatre, art, ballet, museums & classical and contemporary music. The Royal Festival Hall, the Hayward Gallery, the British Film Institute, the National Theatre, Tate Modern, the Old & Young Vic Theatres and Shakespeare's Globe attract visitors from all over the world.

Across the river, the Palace of Westminster, St Paul's Cathedral, Buckingham Palace, and other historic landmarks are just minutes away.



Shakespeare's Globe Theatre



The Royal Festival Hall



BFI IMAX Cinema



The Design Museum





The OXO Tower restaurant



The OXO Tower



Roast restaurant



The Shard - Hutong restaurant



Wright Brothers restaurant

## RIVERSIDE RENAISSANCE

Stretching from Westminster Bridge in the west, to Tower Bridge in the east, One Blackfriars is located on the capital's most vibrant riverside destination. Renowned for its exciting, cosmopolitan restaurants and bars, with artisan and specialist producers at historic Borough Market, the area attracts a collection of London's best restaurants, such as fish and seafood specialists Wright Brothers and British seasonal produce at Roast, in the heart of Borough Market. Enjoy breathtaking, panoramic views of the city from The Shard, whilst dining at Hutong, Oblix or Aqua Shard. Close to the Old and Young Vic Theatres, watch the River Thames go by at Blueprint Café at the Design Museum, or the views across to the Palace of Westminster from Skylon at the Royal Festival Hall.





Computer enhanced view image is indicative only.



# ONE LIFESTYLE

Distinctive interior design, attention to detail and first-class specification in sleek kitchens, elegant living and dining rooms, stylish bedrooms and bathrooms combine with great space and fabulous panoramic views to offer unrivalled London living.



Computer generated image of a Turner living room is indicative only.





View from the 50th floor of One Blackfriars is indicative only.

---

## A POINT OF VIEW

From first light in the east as the sun rises over the City, to the setting sun in the west, floor to ceiling windows provide an ever-changing view on London life.

A single glazed outer façade wraps around the building to provide a distinctive profile of the Tower.

Sleek, sweeping living areas create a perfect backdrop for entertaining.

---



---

## DISTINGUISHED DINING

Enjoy long, lingering lunches or intimate dinner parties in the sophisticated kitchen and dining areas – a setting designed to impress.

Chic decor and the latest high specification appliances offer the perfect space for formal and informal entertaining.

---



Computer generated image of a Hepworth kitchen is indicative only.





Computer generated image of a Hepworth bedroom is indicative only.



Computer generated image of a Gainsborough bathroom is indicative only.



## BESPOKE HAVENS

Bathrooms, shower rooms and en-suites feature heated wall panels and overhead rain showers. All have a clever mix of finishes using stone, timber, leather, glass and gleaming chrome combined with feature lighting.

Every aspect of One Blackfriars underlines its status as London's most coveted new landmark. Craftsmanship, bespoke design, mood lighting, the latest technology plus unparalleled quality of materials and finishes elevate the Tower to a new level of living in the capital.

Bedrooms are elegant havens where stylish design specifications include fitted wardrobes and integrated storage solutions.





View from the 30th floor of One Blackfriars taken with a wide angle lens is indicative only



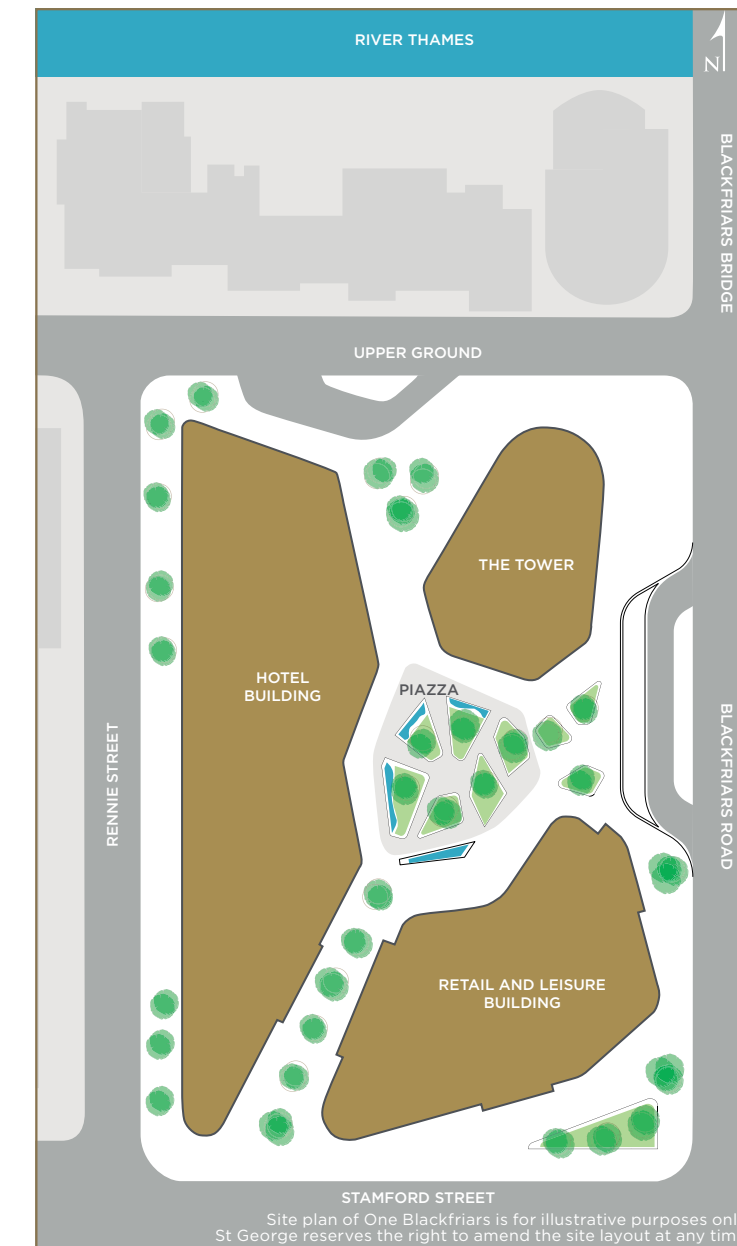

# ONE PLACE

A discreet, private world with a first-class approach to living distinguishes One Blackfriars. A gym, thermal suite, golf simulator, screening room, 32nd floor executive lounge and a residents' wine cellar are among the facilities available to residents. This exclusive leisure area is accessed via a private route from the Tower into the Retail and Leisure building.

The One Blackfriars Tower will be complemented by a high-quality boutique hotel. The hotel, another bespoke design by Ian Simpson, will be commensurate with the exceptional architectural quality of the public realm.

The hotel will add value to the piazza and will feature a quality dining experience for residents of the Tower.

The Retail and Leisure building will sit to the south of the Tower, offering high-quality retail units. At the heart of One Blackfriars, the beautifully landscaped piazza with a water feature creates the destination.





## OUTSTANDING SERVICE

An exceptional level of service is on offer to all residents at One Blackfriars, provided by Harrods Estates Asset Management. A dedicated concierge is on hand at all times to manage residents' requirements, from organising travel arrangements, dinner parties, PA services or tickets to events.

HARRODS ESTATES  
ASSET MANAGEMENT



Computer generated image of One Blackfriars entrance foyer is indicative only.





Computer generated image of residents' swimming pool is indicative only.

---

## RESTORING BODY AND SPIRIT

With its stunning pool with hydrotherapy and heated loungers, the elegant residents' spa provides a calm oasis away from the demands of London life.

---



Photography of previous St George resident's gym is indicative only.





---

## EXTREME INDULGENCE

The thermal suite offers an invigorating range of facilities. Enjoy a water massage in the Vichy shower, experience the arctic chill of the snow cabin and ice fountain, and relax in the heat of the suite's sauna and steam room. Sounds, music and an experience shower will restore the body and spirit in the wet room. A private room will also be available within the spa for the latest treatments to enhance health and well-being.

The fitness suite has a state-of-the-art gym overlooking a private garden space, which allows for residents' relaxation.

---



Computer generated image of residents' thermal suite is indicative only.





Computer generated image of residents' private screening room is indicative only.



---

## PRIVATE VIEW

An elegant, private screening room with refreshment area has been created at One Blackfriars exclusively for residents, where friends can gather and film parties can be arranged.

---





## MASTERS OF WINE

For wine connoisseurs, One Blackfriars has its own cellar, where residents can hire chilled private wine storage. Controlled temperature and humidity settings create the perfect conditions for storing fine wines.

One of London's premier wine and tasting experiences is close by at Vinopolis, near London Bridge, where more than 100 international wines and spirits can be sampled. For the truly discerning, Mayfair's auction houses and wine merchants offer treasures from the world's most coveted private collections.



Computer generated image of residents' wine cellar is indicative only.





Computer generated image of 32nd floor executive lounge is indicative only.

---

## AN EXCLUSIVE PRIVATE CLUB

Located on the 32nd floor, with a dazzling view over St Paul's and the City and west towards the Houses of Parliament, an executive lounge is available for private bookings by residents.

A dining table for guests can be pre-booked, perfect for a drinks reception, dinner party or an intimate business event. There is a dedicated kitchen for caterers plus integral AV technology so the dining area can also be used for meetings and presentations.

---





## ONE LONDON

The capital is a world-class city – clever, dynamic and exhilarating – and One Blackfriars is at the heart of this exciting lifestyle. Always ahead of the crowd, where London leads, other cities follow – in fashion, art, architecture, culture and innovation. One Blackfriars is now setting the agenda as the most coveted place to live.

## SHOPPING

London's smartest shops and an array of global brands are just a short drive away in Knightsbridge, Mayfair and Chelsea, along with niche designer boutiques with international cachet.





Criterion Restaurant, Piccadilly



The Ritz, Piccadilly



Alain Ducasse at The Dorchester, Mayfair

---

## A TASTE OF LONDON

Michelin-starred restaurants, smart brasseries, bars and exclusive clubs offer the world's best dining experiences in the heart of the capital – where the movers and shakers of fashionable London socialise.

---



Royal Exchange Grand Café, The City of London





Royal Festival Hall



The British Museum



West End Theatre Land



The Royal Ballet



The Royal Opera House



The Old Vic



The Tate Modern

## SHOWCASE

London has an acclaimed arts scene – spanning ballet, opera, theatre, music and art. Its many internationally-renowned galleries and museums showcase treasures, luxuries and masterpieces from around the world, whilst the West End is a carousel of entertainment to suit all tastes – all a short distance from One Blackfriars.





Royal Horse Guard



Big Ben and Houses of Parliament



Royal Albert Hall



Buckingham Palace

## CAPITAL ATTRACTIONS

Thousands of years of history and heritage have shaped a rich pageant of London life, from the majesty and celebrated traditions of the Royal Family at Buckingham Palace, to the Palace of Westminster where one of the world's oldest parliaments sits in the shadow of Big Ben.



Tower Bridge





Computer generated image of One Blackfriars is indicative only.



King's College London

---

## BRIGHTEST AND THE BEST

London's universities and schools are renowned throughout the world, offering the very best educational opportunities fitting for the capital's status as a world financial centre. Schools such as Westminster, St Paul's and Harrow have educated world leaders and captains of industry. Leading universities include University College, King's College, Imperial College, and the London School of Economics, and all enjoy world ranking in academic excellence, while highly respected teaching hospitals offer unrivalled medical training.

---





EUROSTAR



LONDON CITY AIRPORT 8.4 miles



KING'S CROSS ST PANCRAS INTERNATIONAL 2.3 miles



HEATHROW AIRPORT 20.4 miles



LONDON BATTERSEA HELIPORT 5.3 miles



## TRANSPORT

The location of One Blackfriars provides excellent access to all parts of London; close to transport hubs, road networks, helicopter and airport links at Gatwick, Heathrow and London City Airport. Waterloo, Blackfriars and London Bridge stations are close by and provide fast links to the south of England. King's Cross St Pancras International provides fast access to Europe via Eurostar and to the port of Dover. London Heliport, along the river at Battersea, is twenty minutes from One Blackfriars.

## Airport by car

LONDON CITY	8.4	miles
HEATHROW	20.4	miles
GATWICK	29	miles
STANSTED	37	miles

## Flight times from London

ABU DHABI	06 hrs 40 mins	KUALA LUMPUR	12 hrs 51 mins	PARIS	00 hrs 53 mins
BANGKOK	11 hrs 37 mins	LOS ANGELES	10 hrs 40 mins	RIO DE JANEIRO	11 hrs 18 mins
BEIJING	09 hrs 55 mins	MOSCOW	03 hrs 53 mins	ROME	02 hrs 17 mins
DUBAI	06 hrs 40 mins	MUMBAI	08 hrs 46 mins	SHANGHAI	11 hrs 12 mins
HONG KONG	11 hrs 42 mins	NEW DELHI	08 hrs 10 mins	SINGAPORE	13 hrs 13 mins
ISTANBUL	03 hrs 53 mins	NEW YORK CITY	06 hrs 47 mins	TOKYO	11 hrs 39 mins
JAKARTA	14 hrs 16 mins	NICE	01 hrs 58 mins	ZURICH	02 hrs 00 mins





WATERLOO STATION 0.6 miles



LONDON RIVER TAXI 0.4 miles



SOUTHWARK STATION 0.4 miles



BLACKFRIARS STATION 0.5 miles



LONDON BRIDGE STATION 0.8 miles



Map not to scale.

## LONDON TRAVEL

One Blackfriars is perfectly positioned for the best that the capital has to offer. For travelling within London, private car hire and taxis can be organised by the concierge at One Blackfriars. Underground stations at Blackfriars, Southwark, Waterloo and London Bridge provide fast access to businesses, shops, entertainment and international travel. There are also regular riverboat services from the London Eye Pier and private water taxis for hire from Festival Pier.

Information correct at time of going to print and are approximate only. Source: [www.theaa.co.uk](http://www.theaa.co.uk)

## CONTACT

Information Centre/Marketing Suite:

Opening hours: Monday to Sunday: 10am - 6pm

1-16 Blackfriars Road, London, SE1 9UF

Tel: +44 (0)20 7871 7188

Email: [oneblackfriarssales@stgeorgesl.com](mailto:oneblackfriarssales@stgeorgesl.com)

[www.oneblackfriars.co.uk](http://www.oneblackfriars.co.uk)

Opening time correct at time of going to print.





View from the 50th floor of One Blackfriars taken with a wide angle lens is indicative only.



# SIMPLY A BETTER WAY OF LIVING

## VISION2020 OUR VISION FOR YOUR FUTURE

Over the years St George has won many prestigious awards for the quality, design and sustainability of our developments. Our Vision2020 strategy is designed to raise our standards higher still.

Vision2020 means that when you buy a new home from St George, you can be safe in the knowledge that it is built to a very high standard of design

and quality, has low environmental impact and that you will enjoy an exceptional customer experience. Vision2020 also means that you are buying a home from a sustainable business that takes its responsibilities towards the environment, its workforce and the communities in which it works, very seriously.

## CREATING SUSTAINABLE COMMUNITIES

- We consult with experts to make sure the homes and places we create are safe and secure
- Our homes are designed to be adaptable to meet the changing needs of individuals and families at different stages of life
- We reduce the impact of the construction process on the local community by ensuring all of our sites are registered with the Considerate Constructors Scheme

## A COMMITMENT TO THE FUTURE

- St George sets targets to reduce water use and CO<sup>2</sup> emissions associated with our construction activities and business operations
- We aim to reuse or recycle a high proportion of our construction, demolition and excavation waste
- The Berkeley Foundation is our way of giving something back to the communities in which we operate. It aims to improve the lives of young people and their communities in London and the South-East of England

## AN EXCEPTIONAL CUSTOMER EXPERIENCE

- Every customer benefits from our St George Customer Satisfaction Commitment
- Dedicated sales teams provide exceptional service throughout the buying process
- Our customer service teams look after your needs after you have moved in

## GREENER, MORE ECONOMICAL HOMES

- Our new homes are designed to use 26% less water and their CO<sup>2</sup> emissions are 76% lower than an average home\*
- This energy and water efficiency can save you around £380 per year on energy bills, and £83 per year on water bills\*
- We provide recycling bins in every home, space to set up a home office and a safe place to store bicycles

Some features are only applicable to selected developments. Please check with the Sales Consultant. \*Savings vary in every home. Figures based on a typical 3 bed Berkeley home achieving Code for Sustainable Homes Level 3. For further details contact: sustainability@berkeleygroup.co.uk

BATTERSEA REACH, LONDON SW18



THE TOWER, ONE ST GEORGE WHARF, LONDON SW8



St George PLC creates residential and mixed-use developments across the capital. The St George portfolio includes Battersea Reach, Putney Wharf, Imperial Wharf and The Tower, One St George Wharf on the banks of the River Thames.

St George PLC has built an impressive reputation and won awards for regenerating disused parts of the capital and transforming them into vibrant communities in attractive landscaped grounds, offering on-site facilities such as fitness suites, business centres, concierge service, shops, cafés and restaurants.

St George PLC specialises in quality mixed-use regeneration schemes participating in the government's 'Constructing Excellence' agenda, and was the first residential developer to be granted 'The Queen's Award for Enterprise: Sustainable Development'.

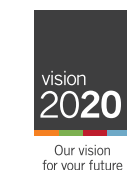

Proud to be a member of the Berkeley Group of companies

Maps are not to scale and show approximate locations only. The information in this brochure is indicative and is intended to act as a guide only as to the finished product. Accordingly, due to St. George's policy of continuous improvement, the finished product may vary from the information provided. These particulars should not be relied upon as accurately describing any of the specific matters described by any order under the Property Misdescriptions Act 1991. This information does not constitute a contract, or warranty. The dimensions given on plans are subject to minor variations and are not intended to be used for carpet sizes, appliance sizes or items of furniture. One Blackfriars is a marketing name and will not necessarily form part of the approved postal address. Applicants are advised to contact the Sales Consultants to ascertain the availability of any particular property. All details correct at time of going to print. August 2013.







Proud to be a member of the Berkeley Group of companies

Tel: +44 (0)20 7871 7188  
[www.oneblackfriars.co.uk](http://www.oneblackfriars.co.uk)